



Email:  
enquiry @aceflo.com



Website:  
www.amegagrp.com



Address:  
No.611.19th Street .Watervliet New York 12189. USA



**AMEGA GROUP**

Partnership:  
ACEFLO ENGINEERING PTE LTD  
www.aceflo.com



**AMEGA PUMPS**

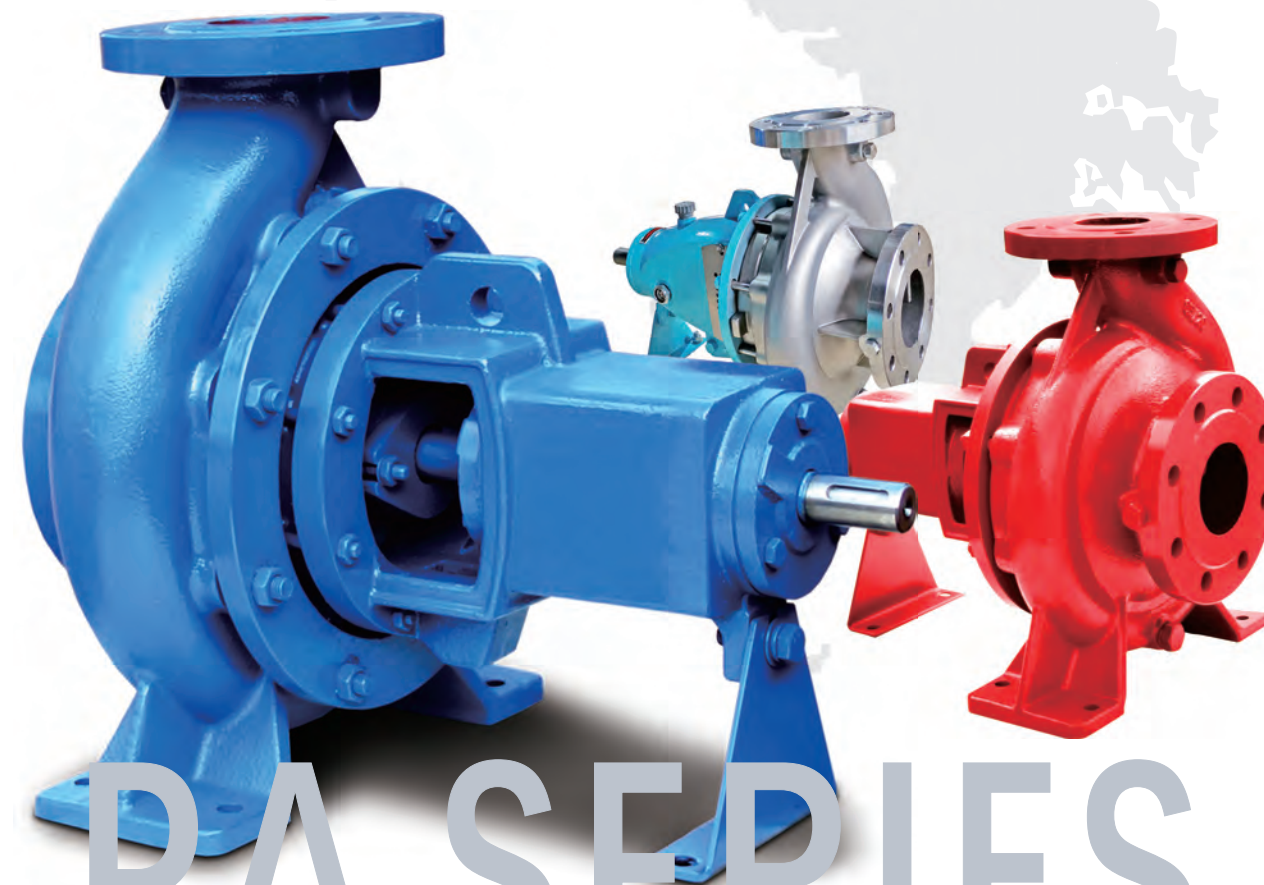

# PA SERIES

DIN24255/EN733 Std End Suction Back Pull-Out Centrifugal Pump



**AMEGA GROUP**

No.611.19th Street .Watervliet New York  
12189.USA www.amegagrp.com

DESIGNED BY AMEGA  
**PUMPS - MOTORS - SYSTEMS**

## key Benefits

AMEGA Pumps are all designed by our engineers, engineered and manufactured at our partners facilities . Our partners are equip with in-house casting foundry , which allow us to stay competitive and having a shorter lead time. We are dedicated to delivering the highest levels of customer satisfaction at all times by offering...

- a dedicated & professional after-sales support team
- a large inventory of components, parts & assemblies at our stock
- a diverse range of configurations to suit various applications
- ISO 9001 certification quality management control system
- a reputation for rugged and reliable pumps that are easily maintained
- experienced drafting & fabrication team for complete customised solutions



## Design & Features

The PA series Back-pull-out Pump is a horizontal end suction, vertical top discharge, single stage, foot mounted centrifugal pump ~ Conforming to BESN733/DIN24255.



The PA series Back-pull-out Pump is a true back-pull-out (BPO) meaning, when configured with a spacer coupling, the electric/diesel motor remains undisturbed in position, while the back plate and rotating assembly can be removed for servicing.

This effective design reduces equipment down time and allows an identical assembly to be reinstalled with minimal service interruption.

BSEN 733/DIN24255 standard ensures dimensional interchangeability with other pumps conforming to this recognised international standard.

This means that PASON Pumps can provide a pump in superior material to directly interchange with other manufacturer's equipment. (No pipe work or motor changes required)

## Applications

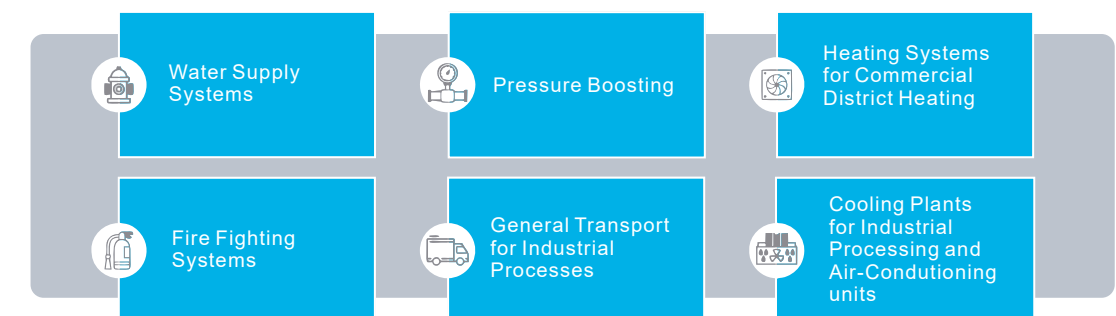



## Model Designation(Examples): PA100-20

PA

Din Series

100

Discharge(mm)

20

Impeller Norminal  
Diameter(cm)

### Design

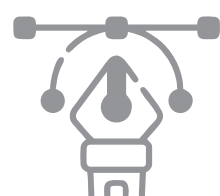

Design	Performance and dimension as per BSEN 733 / DIN24255
Structure	Horizontal ,End suction, Single suction,Volute casing
DN(mm)	Suction size: 50~300, Discharge size: 32~250
Flange	DIN 2501,PN16

### Material

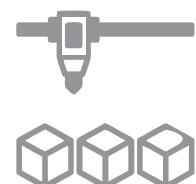

Pump parts	Material
Casing / Impeller	Cast iron, Stainless steel
Shaft	Stainless steel
Shaft seal	Mechanical Seal, Gland Packing,Dynamic seal
Bearing lubrication	Grease Life ,Grease, Oil
Bearing Brand	NTN

### Operating Data

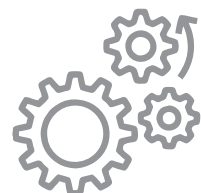

Speed	Up to 3600rpm
Flow Rate(Q)	Up to 1100m3/h-1450rpm 1600m3/h-1750rpm
Head(H)	Up to 160m
Pressure	Up to PN16
Liquid Temperature	Up to 105°C

### Bearing Lubrication

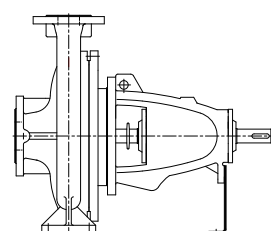

Grease Life

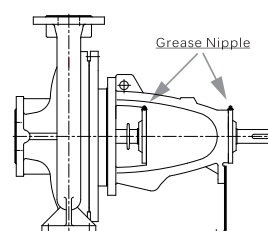

Grease

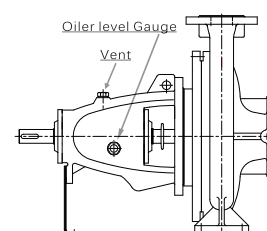

Oil

## Structure Drawing

Pump with Single mechanical seal

S/N	Part Name
1	Pump Casing
2	Impeller Nut
3	Wear Ring
4	Impeller
5	O-Ring
6	Casing Cover
7	Shaft spacer
8	Mechanical Seal
9	Seal Gland
10	Thrower
11	Bearing
12	Bearing Housing
13	Shaft
14	Bearing Cover
15	Support Foot

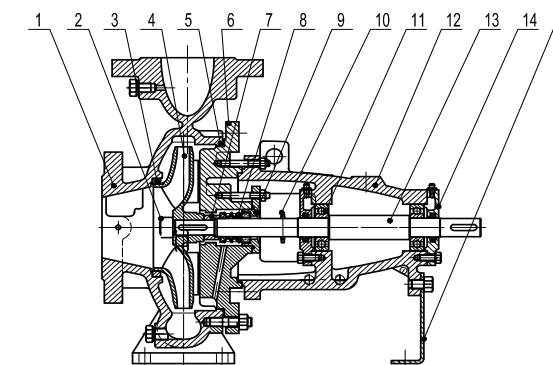

Pump with Gland Packing

S/N	Part Name
1	Pump Casing
2	Impeller Nut
3	Wear Ring
4	Impeller
5	O-Ring
6	Casing Cover
7	Shaft Sleeve
8	Gland Packing
9	Packing Gland
10	Thrower
11	Bearing
12	Bearing Housing
13	Shaft
14	Bearing Cover
15	Support Foot

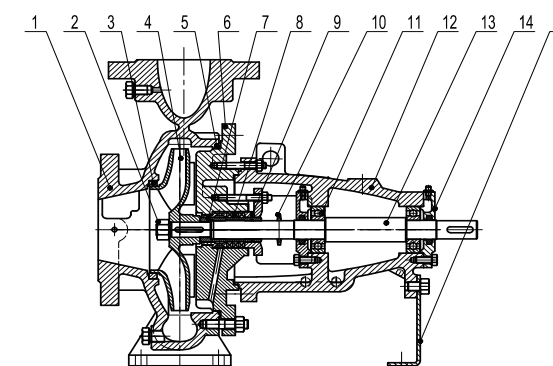

Pump with Dynamic Seal

S/N	Part Name
1	Pump Casing
2	Impeller Nut
3	Wear Ring
4	Impeller
5	Impeller Key
6	casing cover block
7	Vice impeller
8	Casing Cover
9	seal block plate
10	Seal Ring
11	Shaft
12	Thrower
13	Bearing
14	Bearing Housing
15	Bearing Cover
16	Support Foot

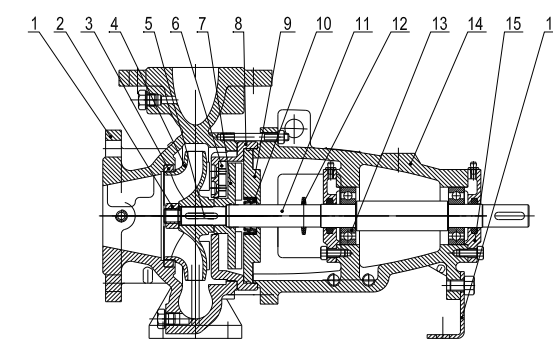

Intalling Dimensions-1

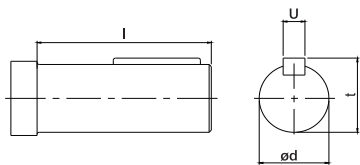

Drive Shaft Dimensions

Bearing housing	ød	l	u	t
25/25A	24	50	8	27
35	32	80	10	35
45	42	110	12	45
55	48	110	14	51

Key dimensions are nominal.

Flange Connecting Dimension( ISO 2084,PN16)

DN	ød	øk	ØD	n	øS
32	73	100	140	4	18
40	83	110	150	4	18
50	98	125	165	4	18
65	118	145	185	4	18
80	133	160	200	8	18
100	153	180	220	8	18
125	183	210	250	8	18
150	209	240	285	8	22
200	264	295	340	12	22
250	320	355	405	12	26
300	375	410	460	12	26

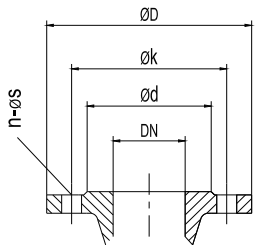

Service Connections

Pump Model	A Casing Drain	B Housing Drain	D Gauge Drain	S Gauge Drain
32-13	1/4	1/4	1/4	1/4
32-16	1/4	1/4	1/4	1/4
32-20	3/8	1/4	1/4	1/4
32-26	3/8	1/4	1/4	1/4
40-13	1/4	1/4	1/4	1/4
40-16	3/8	1/4	1/4	1/4
40-20	3/8	1/4	1/4	1/4
40-26	3/8	1/4	1/4	1/4
40-32	3/8	1/4	1/4	1/4
40-32G	3/8	1/4	1/4	1/4
50-13	1/4	1/4	1/4	1/4
50-16	3/8	1/4	1/4	1/4
50-20	3/8	1/4	1/4	1/4
50-26	3/8	1/4	1/4	1/4
50-26G	3/8	1/4	1/4	1/4
50-32	3/8	1/4	1/4	1/4
50-32G	3/8	1/4	1/4	1/4
65-13	3/8	1/4	1/4	1/4
65-16	3/8	1/4	1/4	1/4
65-20	3/8	1/4	1/4	1/4
65-20G	3/8	1/4	1/4	1/4
65-26	3/8	1/4	1/4	1/4
65-32	3/8	1/4	1/4	1/4
65-32G	3/8	1/4	1/4	1/4
80-16	3/8	1/4	1/4	1/4

Pump Model	A Casing Drain	B Housing Drain	D Gauge Drain	S Gauge Drain
80-20	3/8	1/4	1/4	1/4
80-26	3/8	1/4	1/4	1/4
80-32	3/8	1/4	1/4	1/4
80-32G	3/8	1/4	1/4	1/4
80-40	3/8	1/4	1/4	1/4
100-16	3/8	1/4	1/4	1/4
100-20	3/8	1/4	1/4	1/4
100-26	3/8	1/4	1/4	1/4
100-26G	3/8	1/4	1/4	1/4
100-32	3/8	1/4	1/4	1/4
100-32G	3/8	1/4	1/4	1/4
100-40	3/8	1/4	1/4	1/4
125-20	3/8	1/4	1/4	1/4
125-26	3/8	1/4	1/4	1/4
125-32	3/8	1/4	1/4	1/4
125-40	3/8	1/4	1/4	1/4
150-20	3/8	1/4	1/4	1/4
150-26	3/8	1/4	1/4	1/4
150-32	3/8	1/4	1/4	1/4
150-40	3/8	1/4	1/4	1/4
200-26	3/8	1/4	1/4	1/4
200-32	3/8	1/4	1/4	1/4
200-40	3/8	1/4	1/4	1/4
250-32	3/8	1/4	1/4	1/4
250-40	3/8	1/4	1/4	1/4

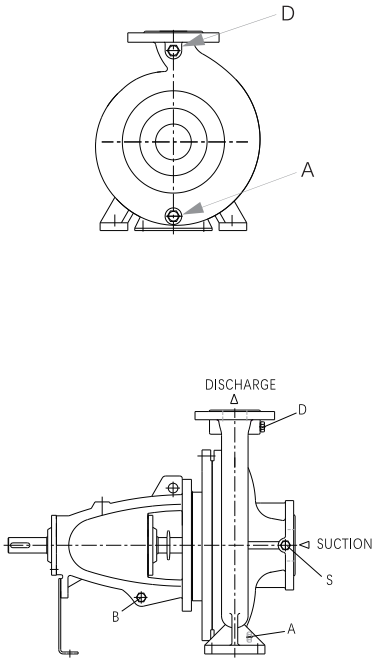

Intalling Dimensions-2

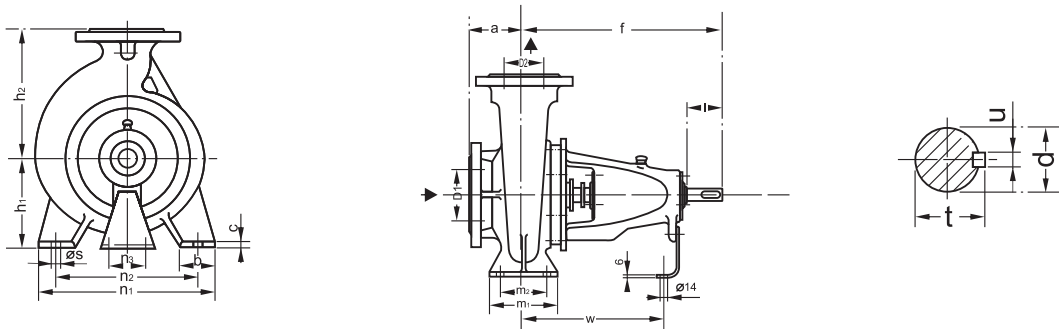

Pump Model	Bearing housing	D2	Pump Dimension							Foot Dimension							Shaft End				Net W.G	
			D1	a	f	h1	h2	b	c	m1	m2	n1	n2	n3	øS	w	d	l	t	u		
32-13	25	32	50	80	360	112	140	50	14	100	70	190	140	100	14	267	24	50	27	8	30	
32-16	25A	32	50	80	360	132	160	50	14	100	70	240	190	100	14	267	24	50	27	8	35	
32-20	25	32	50	80	360	160	180	50	14	100	70	240	190	110	14	267	24	50	27	8	47	
32-26	25A	32	50	100	360	180	225	65	14	125	95	320	250	110	14	267	24	50	27	8	60	
40-13	25	40	65	80	360	112	140	50	14	100	70	210	160	100	14	267	24	50	27	8	31	
40-16	25A	40	65	80	360	132	160	50	14	100	70	240	190	100	14	267	24	50	27	8	37	
40-20	25	40	65	100	360	160	180	50	14	100	70	265	212	110	14	267	24	50	27	8	48	
40-26	25A	40	65	100	360	180	225	65	14	125	95	320	250	110	14	267	24	50	27	8	61	
40-32	35	40	65	125	470	200	250	65	14	125	95	345	280	110	14	342	32	80	35	10	100	
40-32G	45	40	65	125	526	200	250	65	14	125	95	345	280	110	14	367	42	110	45	12	115	
50-13	25	50	65	100	360	132	160	50	14	100	70	240	190	100	14	267	24	50	27	8	35	
50-16	25A	50	65	100	360	160	180	50	14	100	70	265	212	110	14	267	24	50	27	8	40	
50-20	25	50	65	100	360	160	200	50	14	100	70	265	212	110	14	267	24	50	27	8	50	
50-26	25A	50	65	100	360	180	225	65	14	125	95	320	250	110	14	267	24	50	27	8	68	
50-26G	35	50	65	100	470	180	225	65	14	125	95	320	250	110	14	344	32	80	35	10	80	
50-32	35	50	65	125	470	225	280	65	18	125	95	345	280	110	14	342	32	80	35	10	102	
50-32G	45	50	65	125	526	225	280	65	18	125	95	345	280	110	14	367	42	110	45	12	120	
65-13	25	65	80	100	360	160	180	65	14	125	95	280	212	110	14	267	24	50	27	8	41	
65-16	25A	65	80	100	360	160	200	65	14	125	95	280	212	110	14	267	24	50	27	8	47	
65-20	25	65	80	105	360	180	225	65	14	125	95	320	250	110	14	267	24	50	27	8	55	
65-20G	35	65	80	105	465	180	225	65	14	125	95	320	250	110	14	339	32	80	35	10	70	
65-26	35	65	80	100	470	200	250	80	15	160	120	360	280	110	18	342	32	80	35	10	88	
65-32	35	65	80	125	470	225	280	80	18	160	120	400	315	110	18	342	32	80	35	10	115	
65-32G	45	65	80	125	526	225	280	80	18	160	120	400	315	110	18	367	42	110	45	12	130	
80-16	25A	80	100	125	360	180	225	65	14	125	95	320	250	110	14	267	24	50	27	8	53	
80-20	35	80	100	125	470	180	250	65	15	125	95	35	345	280	110	14	342	32	80	35	10	78
80-26	35	80	100	125	470	200	280	80	15	160	120	400	315	110	18	342	32	80	35	10	98	
80-32	35	80	100	125	470	250	315	80	16	160	120	400	315	110	18	342	32	80	35	10	120	
80-32G	45	80	100	125	526	250	315	80	16	160	120	400	315	110	18	367	42	110	45	12	140	
80-40	45	80	100	125	530	280	355	83	18	160	120	440	340	110	18	370	42	110	45	12	169	
100-16	35	100	125	125	470	200	250	80	15	160	120	360	280	110	18	342	32	80	35	10	87	
100-20	35	100	125	125	470	200	280	80	16	160	120	360	280	110	18	342	32	80	35	10	85	
100-26	35	100	125	140	470	225	280	80	16	160	120	400	315	110	18	342	32	80	35	10	105	
100-26G	45	100	125	140	526	225	280	80	16	160	120	400	315	110	18	365	42	110	45	12	125	
100-32	35	100	125	140	470	250	315	80	16	160	120	400	315	110	18	342	32	80	35	10	121	
100-32G	45	100	125	140	526	250	315	80	16	160	120	400	315	110	18	367	42	110	45	12	145	
100-40	45	100	125	140	530	280	355	100	20	200	150	500	400	110	23	370	42	110	45	12	176	
125-20	35	125	150	145	470	250	315	80	16	160	120	400	315	110	18	342	32	80	35	10	112	
125-26	35	125	150	140	470	250	355	80	16	160	120	400	315	110	18	342	32	80	35	10	117	
125-32	45	125	150	140	530	280	355	100	18	200	150	500	400	110	23	370	42	110	45	12	160	
125-40	45	125	150	160	530	315	400	100	18	200	150	500	400	110	23	370	42	110	45	12	193	
150-20	35	150	200	160	497	280	400	100	18	200	150	400	315	110	23	367	32	80	35	10	133	
150-26	45	150	200	160	530	250	355	100	18	200	150	450	350	110	23	370	42	110	45	12	163	
150-32	45	150	200	160	530	280	400	100	18	200	150	550	450	110	23	370	42	110	45	12	180	
150-40	45	150	200	160	530	315	450	100	18	200	150	550	450	110	23	370	42	110	45	12	215	
200-26	45	200	250	180	555	315	450	100	20	200	150	550	450	110	28	392	42	110	45	12	226	
200-32	55	200	250	180	670	315	480	120	20	220	170	600	480	110	28	505	48	110	51	14	280	
200-40	55	200	250	180	670	335	480	120	20	220	170	600	480	110	28	505	48	110	51	14	338	
250-32	55	250	300	220	691	355	520	150	26	250	200	660	510	110	28	525	48	110	51	14	370	
250-40	55	250	300	220	682	400	560	150	26	250	200	660	510	110	28	516	48	110	51	14	400	





AMEGA PUMPS

## Performance Chart (50Hz)

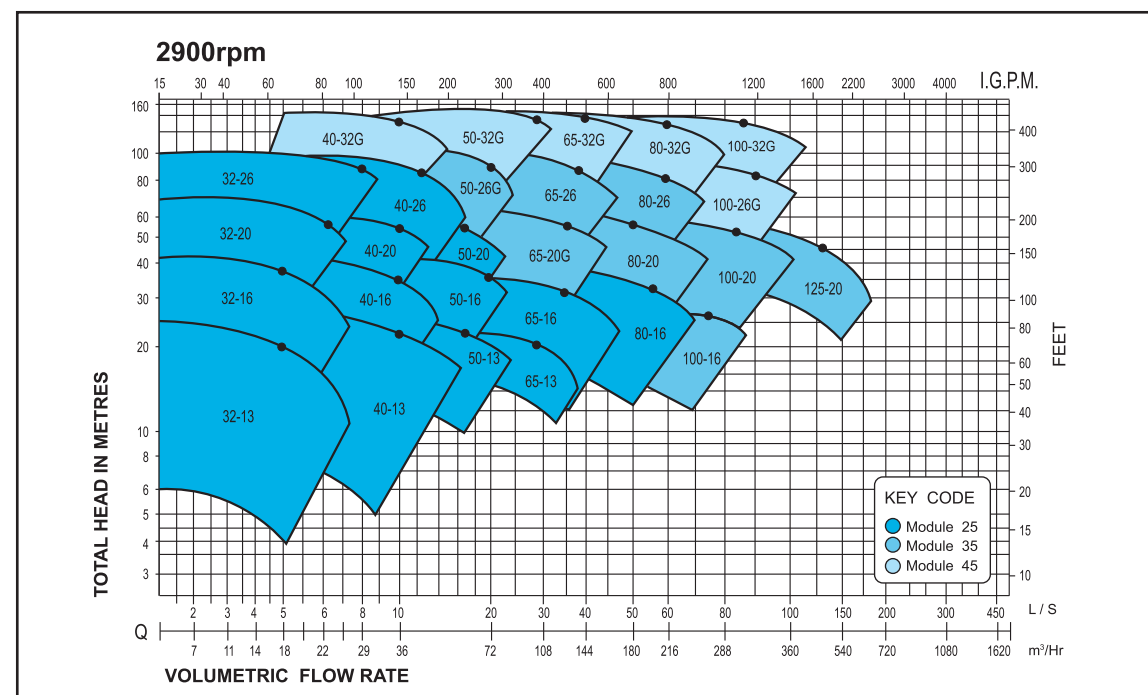

## Performance Chart (60Hz)

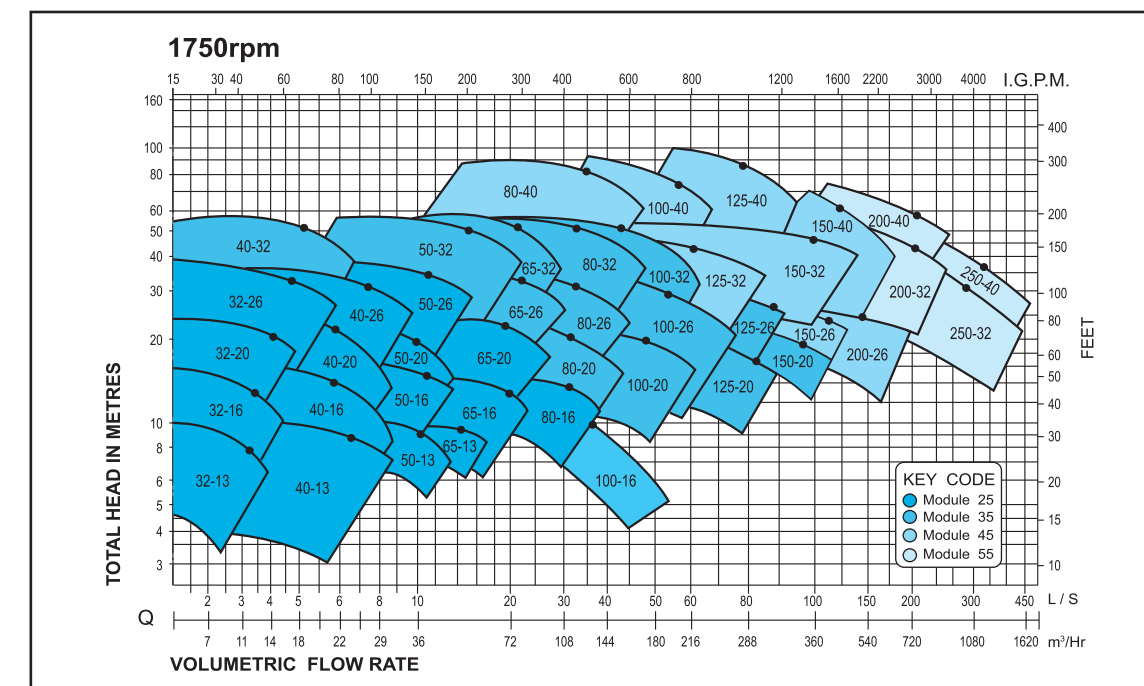
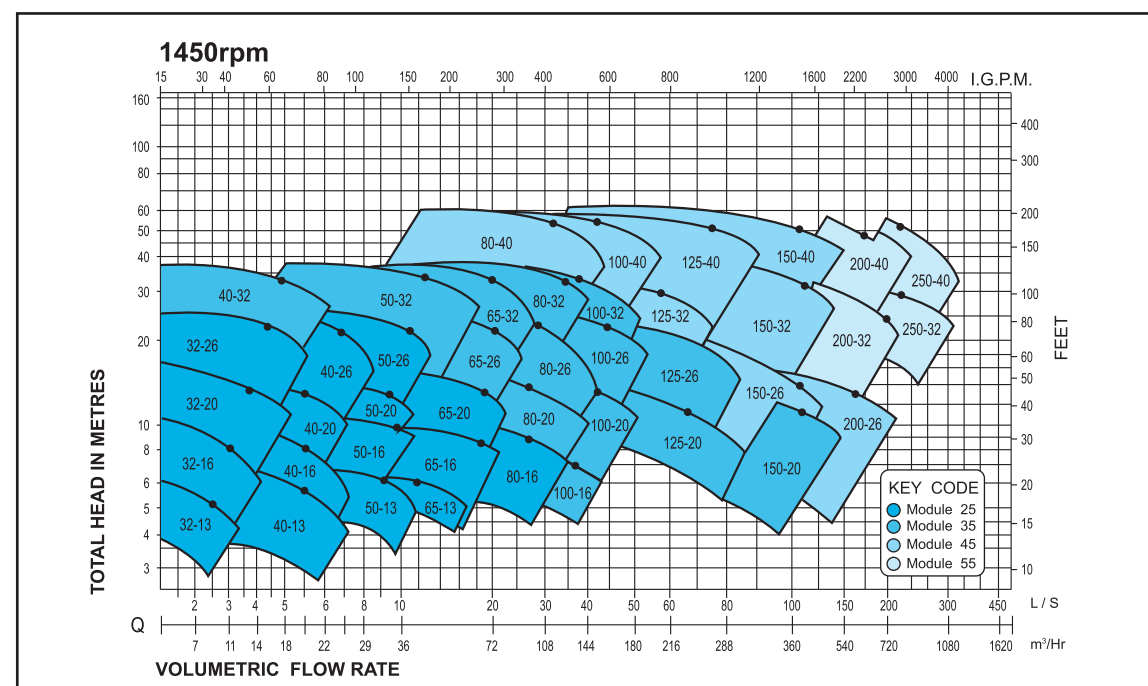
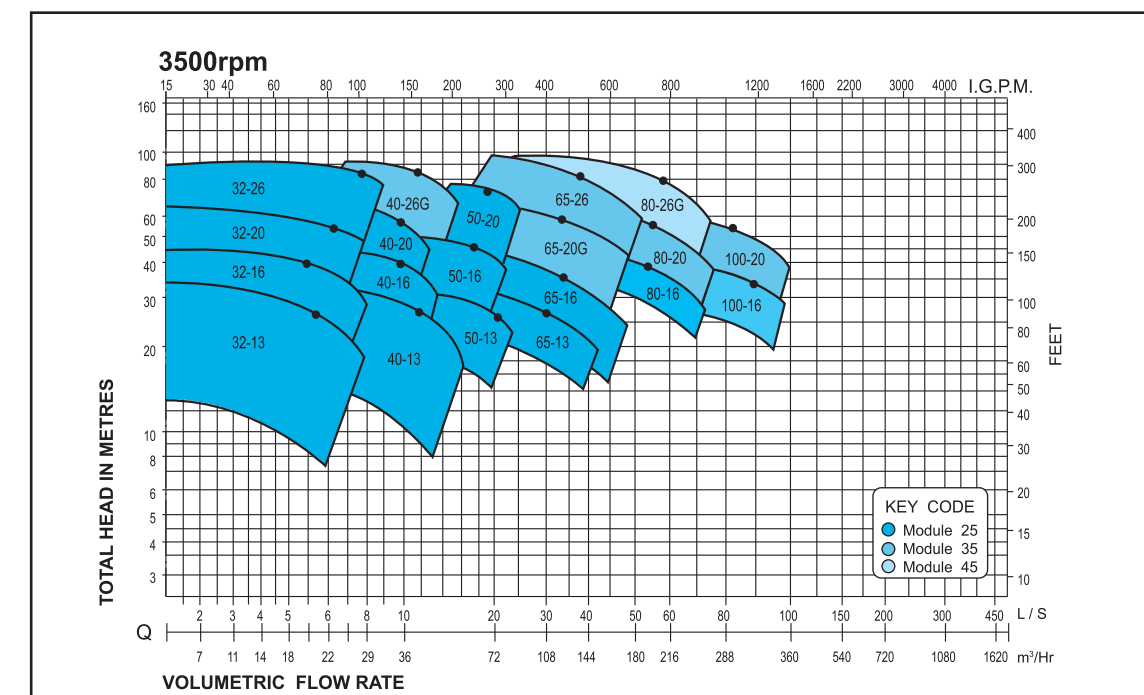





AMEGA PUMPS

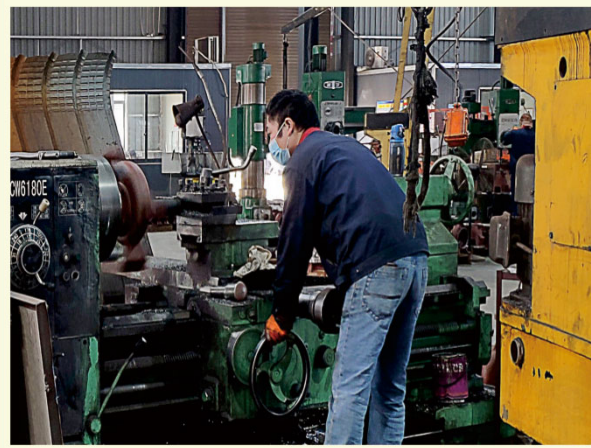

OUR PURSUIT OF QUALITY  
IS ALWAYS THE SAME.

